

MODEL 14167 15 CUBIC FOOT CAPACITY BEAR-PROOF FOOD STORAGE LOCKER

This 15 cubic foot unit has enough room for trailheads, day use areas, tent areas & small campsites. Optional padlock hasp provides even further security.



#14167 IGBC
Certification
Number 3775

- Door hinges are heavy duty stainless steel for superior corrosion resistance and longevity.
- Bear-proof 2 point self latching system with an inner, easy to operate child safety latch release mechanism.
- Unit is fully framed using 1-1/2" x .120" thick wall square tubing with upper and lower panel center supports. Doors are fully framed using 1.0" x .060" thick wall square tubing. Also with middle center supports.
- Housing and door skins are welded 12-gauge steel.
- 1/4" thick mounting plates for 1/2" anchor bolts. (See dimensions shown below)
- Powder coated for superior corrosion protection. Available in Forest Green, Blue, Brown, and Gray.

EST. Weight = 310 Lbs.

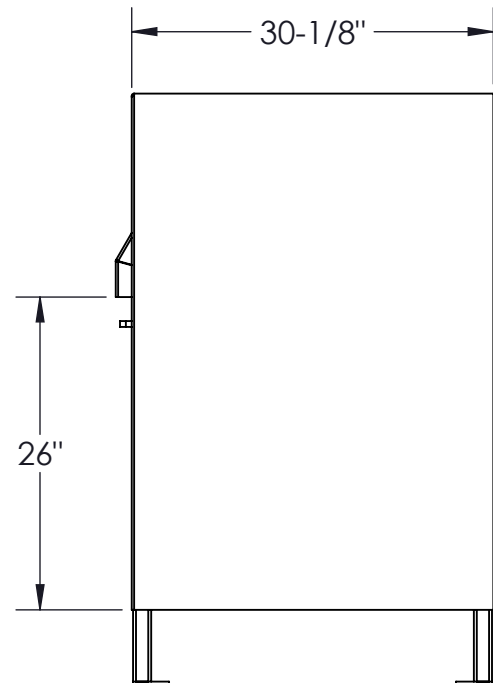
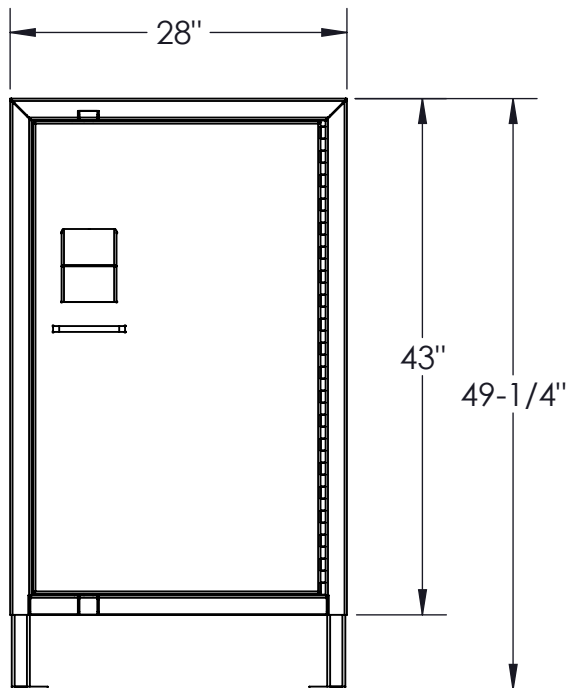
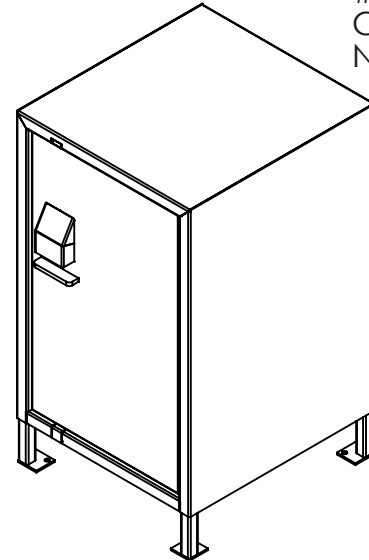

WARNING: MUST BE PERMANENTLY MOUNTED

CUSTOMER APPROVAL :

DATE :

JAMESTOWN
ADVANCED
PRODUCTS
CORPORATION

THIS DRAWING, WHICH CONTAINS PROPRIETARY INFORMATION, IS THE PROPERTY OF JAMESTOWN ADVANCED PRODUCTS CORPORATION. IT SHALL NOT BE REPRODUCED IN ANY MANNER NOR DISCLOSED TO THIRD PARTIES WITHOUT WRITTEN PERMISSION OF JAMESTOWN ADVANCED PRODUCTS CORPORATION.

DATE : 9/6/16

PRODUCT PART NUMBER : 14167

REV. NO. 3 9/6/16

PRODUCT DESCRIPTION :

15 CUBIC FOOT BEAR-PROOF FOOD LOCKER

2855 GIRTS ROAD
JAMESTOWN, NY 14701

PHONE 800-452-0639 -- FAX 716-483-5398 -- WWW.JAMESTOWNADVANCED.COM