

- ALL WELDED CONSTRUCTION USING 2" SCH 40 PIPE, AND 14 GA. PERFORATED STEEL.
- AVAILABLE IN SURFACE MOUNT OR IN-GROUND MOUNT.
- SURFACE MOUNT PLATES ARE CONSTRUCTED OF 3/16" THICK STEEL.
- IN-GROUND MOUNT FEET POSTS HAVE A 1" X 5-1/2" 12 GA. STEEL ANCHOR MADE TO BE EMBEDDED IN CEMENT.
- BENCHES ARE AVAILABLE IN THERMOPLASTIC COATING OR POWDER COAT FINISH.

	SURFACE MOUNT			IN-GROUND MOUNT		
	4FT	6FT	8FT	4FT	6FT	8FT
PART#	13360-1	13360-3	13360-5	13360-2	13360-4	13360-6
APPROX. WEIGHT	75	100	120	85	110	130

PARTIAL PERF PATTERN SHOWN FOR DISPLAY ONLY. ACTUAL SEAT IS 100% PERFORATED STEEL

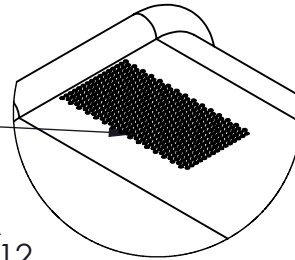

DETAIL A  
SCALE 1 : 12

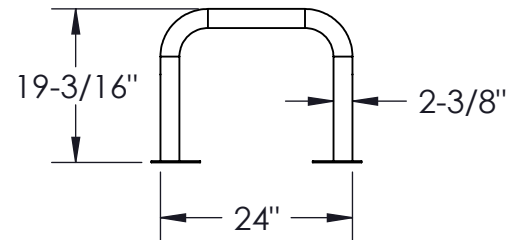
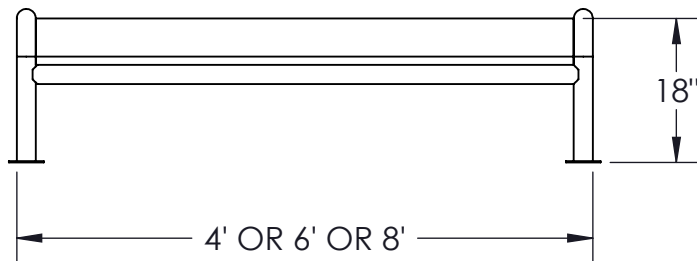
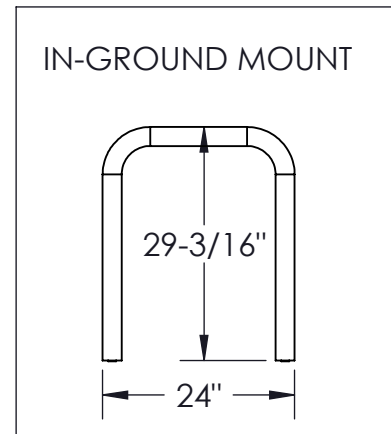
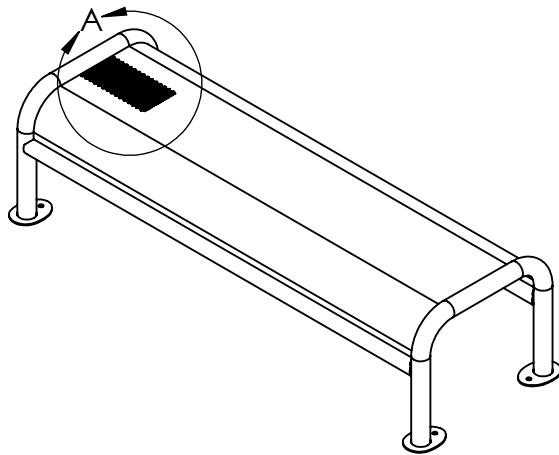

**WARNING: MUST BE PERMANENTLY MOUNTED**

CUSTOMER APPROVAL :

DATE :

**JAMESTOWN**  
ADVANCED  
PRODUCTS  
CORPORATION

THIS DRAWING, WHICH CONTAINS PROPRIETARY INFORMATION, IS THE PROPERTY OF JAMESTOWN ADVANCED PRODUCTS CORPORATION. IT SHALL NOT BE REPRODUCED IN ANY MANNER NOR DISCLOSED TO THIRD PARTIES WITHOUT WRITTEN PERMISSION OF JAMESTOWN ADVANCED PRODUCTS CORPORATION.

DATE : 1 / 7 / 2011

PRODUCT PART NUMBER : 13360-1THRU-6

REV. NO. 2 12/10/15

PRODUCT DESCRIPTION :

PERFORATED BACKLESS BENCH

2855 GIRTS ROAD  
JAMESTOWN, NY 14701

PHONE 800-452-0639 -- FAX 716-483-5398 -- WWW.JAMESTOWNADVANCED.COM